

Assembly instructions for the SimPlexity V12 cockpit

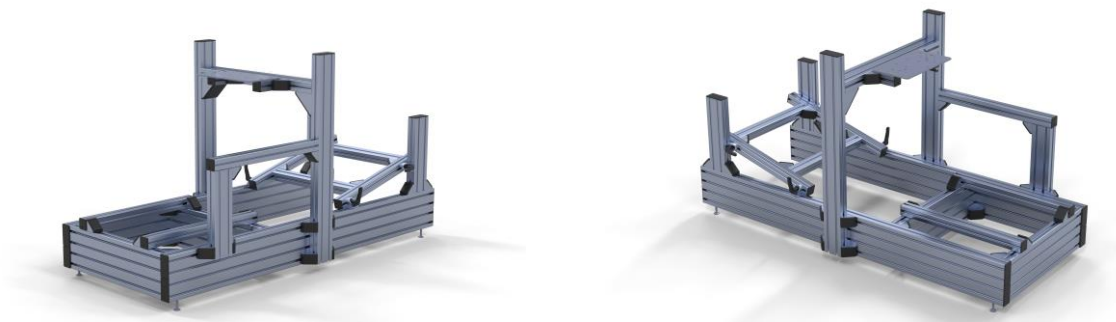

In order to make everything easy to identify we have color coded the aluminum profiles.

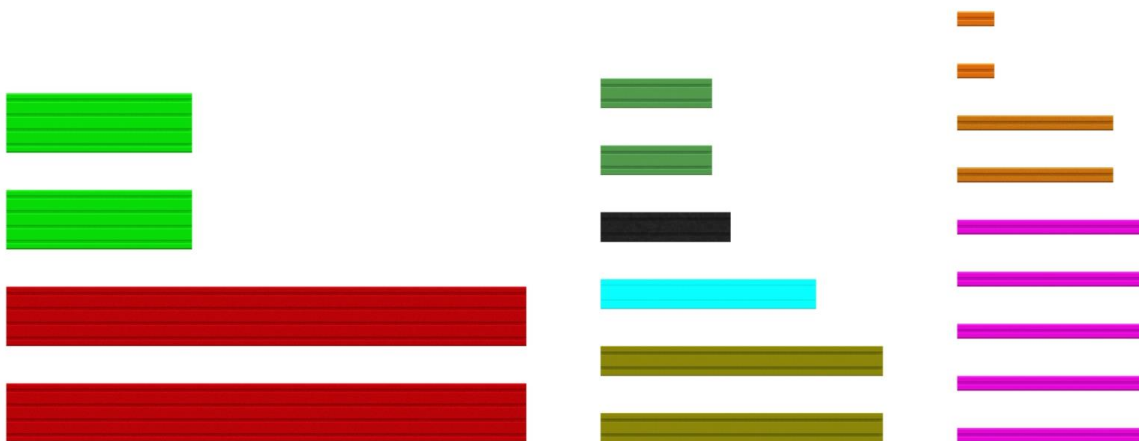

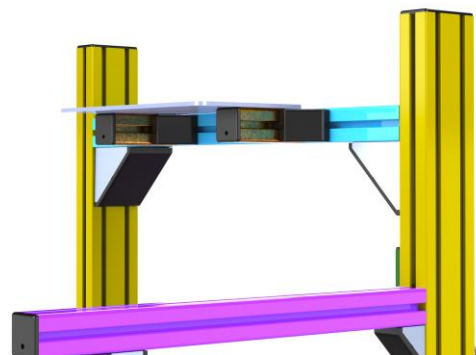
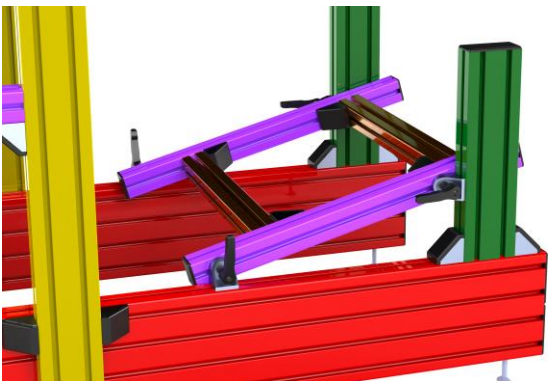
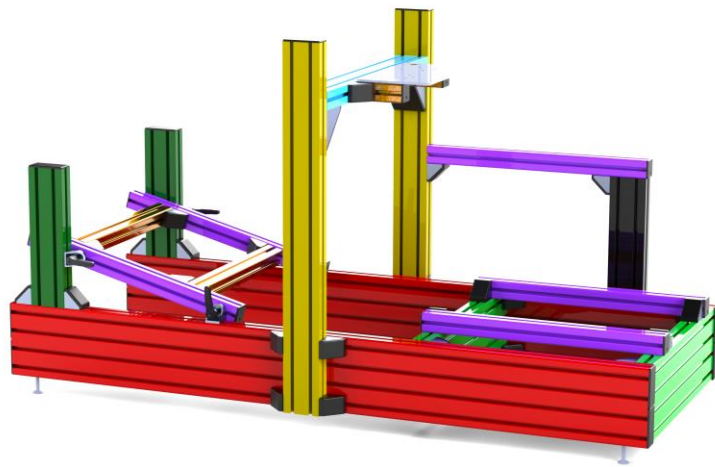
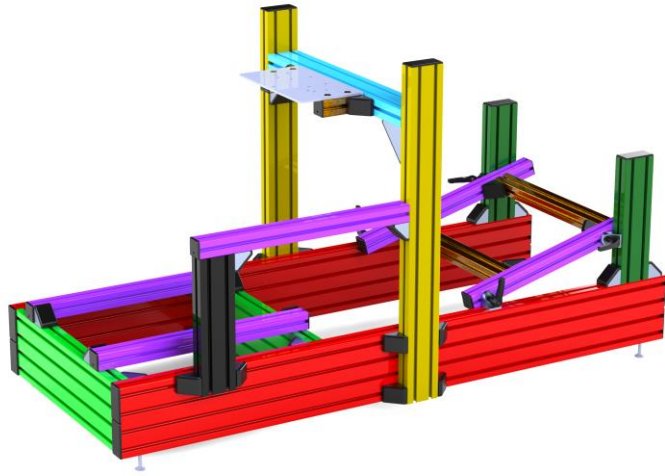

The following picture demonstrates the how the brackets are attached to the profiles.

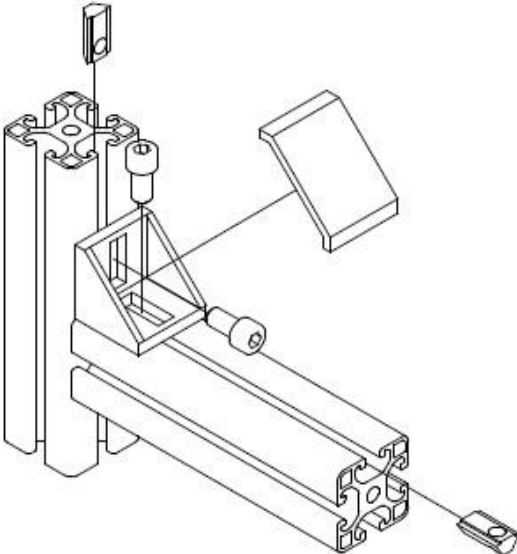

In some cases you will have to break off the guiding feet of the brackets. That can be easily done by prying them with a screwdriver.

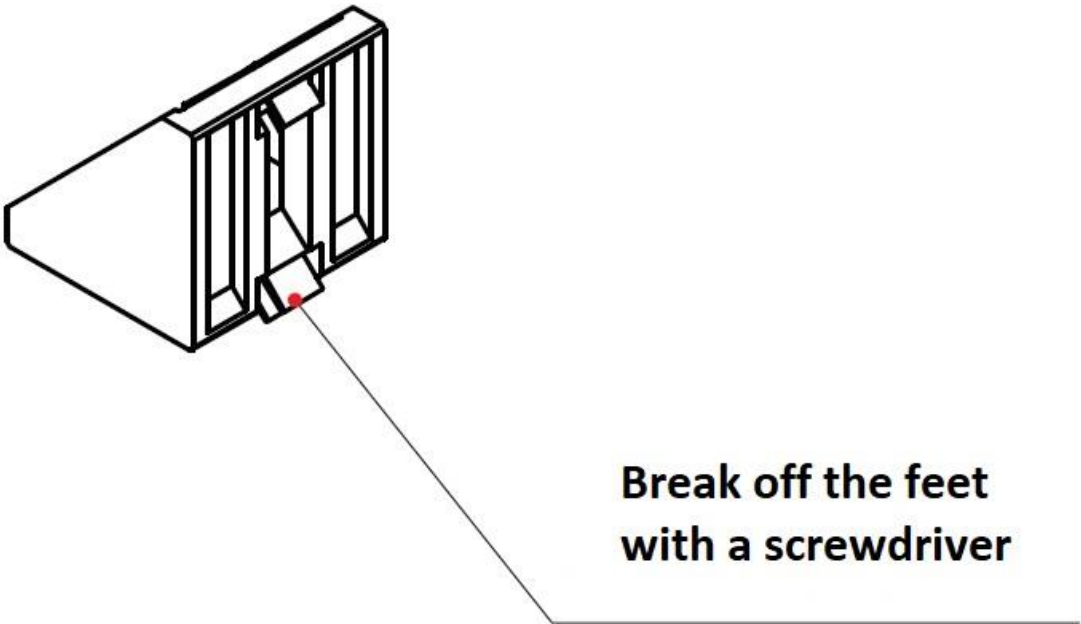

Tips:

- It is a good idea to start by building the base of the cockpit. For this you will need two **red** 40x160 and two **green** 40x160 profiles. The two **green** profiles should not be farther than 42cm from each other. The distance can easily be approximated by using one of the **purple** 40x40 profile as they are 50cm long. The feet can be attached now as well. Make sure the ones that will be under the seat are about 10 cm away from the end of the cockpit.
- After the base is assembled, it is a good idea to assemble the pedal frame and adjust it to fit the pedals. For this you will need two **brown** 40x40 profiles and two **purple** 40x40 profiles.
- The remaining steps can be done in any order.
- When attaching the wheel plate, first attach the two **brown** 40x40 profiles (the shortest ones) to the wheel plate itself using the countersunk screws. Afterwards attach a bracket on the outside of the profiles and then the entire assembly to the **light blue** horizontal 40x80 profile. You can now remove the wheel plate and attach the inner brackets.



Countersunk screws

- As a general recommendation to make the adjustment of the cockpit easier, for a person with a height of approximately 180cm, the **yellow** upright 40x80 profiles should be 70cm from the seat end of the cockpit. The **light blue** horizontal 40x80 profile on which the wheel plate is attached should be approximately 10cm from the top of the **yellow** 40x80 profile.
- Make sure everything is tight and hit the track! 😊